

## MAGNETIC CHECK VALVE SERIES | *CCV*



The CCV series magnetic check valve is applicable for all air conditioning or refrigeration systems requiring a means to direct refrigerant flow in a circuit.

### FEATURES

- LOW INTERNAL SEAT LEAKAGE
- BUILT-IN 30 MESH STRAINER
- SOLID COPPER OR STAINLESS STEEL CONSTRUCTION

### GENERAL SPECIFICATION

- Applicable for all common HCFC, non-flammable HFC and HFO refrigerants such as: R-22, R134a, R404A, R-407C, R-410A, R-507
- Ambient temperature min./max. -40°F / +250°F
- Maximum working pressure (PS): 700 psig
- Maximum operating pressure differential: 520 psig
- Installation position: In any position except on a vertical line with refrigerant flow in the downward direction
- Certification: UL

## MAGNETIC CHECK VALVE SERIES | CCV

### GENERAL CHARACTERISTICS

1/4" ODF thru 5/8" ODF

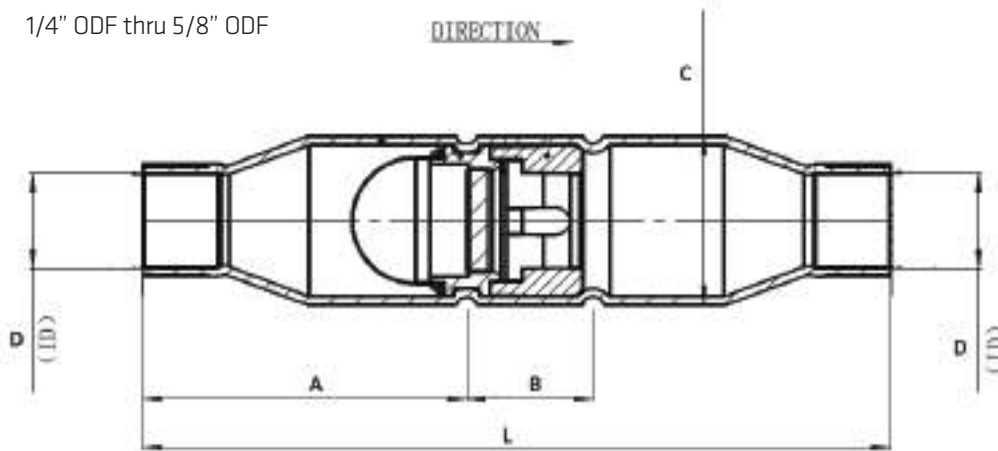

7/8" ODF thru 1-3/8" ODF

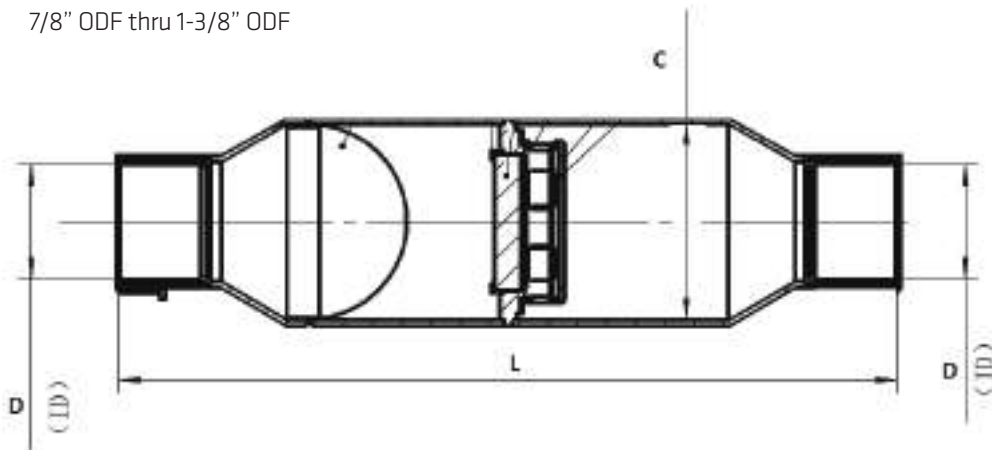

Model Number	Dimensions & Construction					Body Material
	D	L	A	B	C	
	ODF (in)	(in)	(in)	(in)	(in)	
CCV10-021	1/4	4.00	1.77	0.71	0.78	Copper
CCV10-019	3/8	4.00	1.77	0.71	0.87	Copper
CCV17-001	1/2	5.00	2.17	0.85	1.13	Copper
CCV17-017	5/8	5.00	2.17	0.85	1.13	Copper
CCV25-020	7/8	6.99	N/A	N/A	1.54	Stainless Steel
CCV32-001	1-1/8	8.37	N/A	N/A	2.01	Stainless Steel
CCV38-001	1-3/8	9.41	N/A	N/A	2.50	Stainless Steel